

635nm 0.5W Laser Diode| High Power 500mw LD

635nm LD 500mW High Power| TO 3 Package

WSLD-635-500m-3

Wavespectrum Laser, Inc.

www.wavespectrum-laser.com

635nm Laser Diode 500mw		Wavespectrum Laser, Inc	
PARAMETER	SYMBOL	VALUE	UNIT
Reverse Voltage	$V_r$	2.0	V
Operating Temperature	$T_{op}$	+10~+25	°C
Storage Temperature	$T_{stg}$	-40 ~ +85	°C
Lead soldering temperature (10 sec.)	$T_{is}$	280	°C
<b>Features:</b> <ul style="list-style-type: none"> <li>● 635nm</li> <li>● High power ,CW, Multi-mode</li> <li>● High Quality</li> <li>● TO3 package</li> </ul>			
<b>Applications:</b> <ul style="list-style-type: none"> <li>● Medical laser treatment</li> <li>● Laser indicator</li> <li>● Laser detector</li> </ul>			
<b>Specifications</b>		<b>WSLD-635-500m-3</b>	
		<b>Min</b>	<b>Type</b>
Center Wavelength@25°C		630nm	635nm
Spectral Width (FWHM)			1nm
Output Power			500mW
Emitter Area			150x1μm
Beam Divergence (FWHM)			40°± x 10°//
Temperature Coefficient of Wavelength			0.25nm / °C
Slope Efficiency		0.80W/A	0.95W/A
Threshold Current (Typ.)			0.75A
Operating Current (Typ.)			1.20A
Operating Voltage			2.2V
Package Style		TO3/C-mount	



## Spectrum

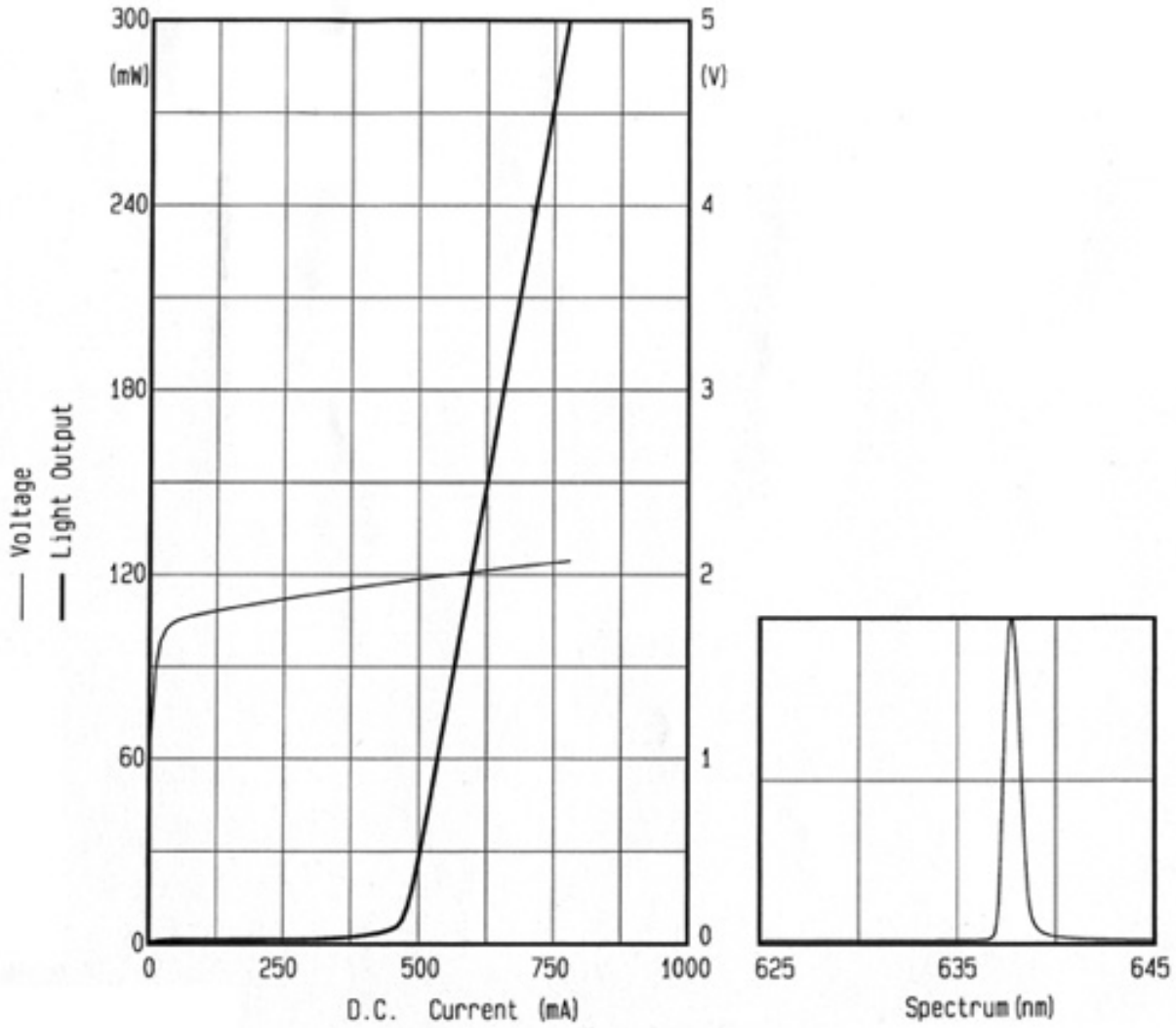

### T03 Package View

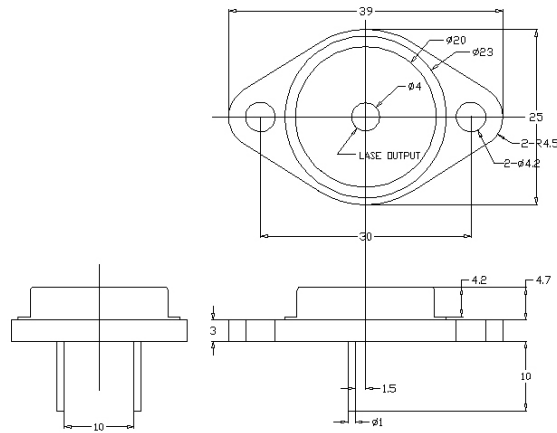

**Electrically shorten LD module and store in non-extreme conditions.  
Suggest using the constant current power supply.**

