

## 808nm 300mw laser diodes with 5.6mm

## 810nm LD 300mw with TO18 Package

WSLD-808-300m-1-PD

Wavespectrum laser inc.

[www.wavespectrum-laser.com](http://www.wavespectrum-laser.com)

808nm Laser Diode		300mw		Wavespectrum Laser, Inc	
Reverse Voltage	$V_r$	2.0		V	
Operating Temperature	$T_{op}$	-10 ~ +40		°C	
Storage Temperature	$T_{stg}$	-40 ~ +80		°C	
Lead soldering temperature (10 sec.)	$T_{is}$	260		°C	
<b>Features:</b> <ul style="list-style-type: none"> <li>• 808nm</li> <li>• CW</li> <li>• TO18 package</li> <li>• <b>Built-in Photodiodes</b></li> </ul>					
<b>Applications:</b> <ul style="list-style-type: none"> <li>• Medical laser treatment</li> <li>• Laser indicator</li> <li>• Laser detector</li> </ul>					
<b>Specifications</b>		<b>WSLD-808-300m-1-PD</b>			
		Min	Type	Max	
Center Wavelength@25°C		805nm	808nm	811nm	
Spectral Width (FWHM)		----	2.0nm	----	
Output Power		----	300mw	----	
Recommended Work Temperature		25°C			
Beam Divergence (FWHM)		$36^\circ \pm x 6^\circ //$	$38^\circ \pm x 8^\circ //$	$40^\circ \pm x 10^\circ //$	
Monitor Current		----	0.3mA	----	
Slope Efficiency		0.7mW/mA	0.95mW/mA	1.1mW/mA	
Threshold Current (Typ.)		----	65mA	100mA	
Operating Current (Typ.)		----	380mA	400mA	
Operating Voltage		----	1.8V	2.2V	
Package Style		TO18			



**TO18(5.6mm) Package View**

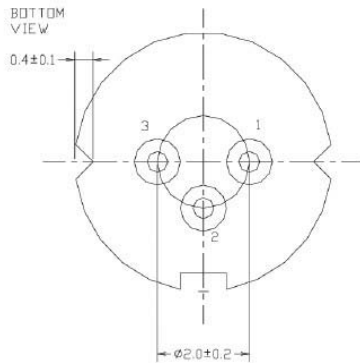

<b>1</b>	<b>LD(-)</b>
<b>2</b>	<b>LD (+) PD (-)</b>
<b>3</b>	<b>PD(+)</b>

Electrically shorten LD module and store in non-extreme conditions.  
Suggest using the constant current power supply.



Please contact us:

Website: [www.wavespectrum-laser.com](http://www.wavespectrum-laser.com) (for more detailed information)

Email: [info@wavespectrum-laser.com](mailto:info@wavespectrum-laser.com) (for inquiry about this product)

