

405nm 150mW~160mW Fiber Coupled LD with 50um Multi-mode Fiber
405nm 150mW Coaxial Pigtailed Diode Laser Module | Violet LD Module with 50um 105um UV Fiber
WSLP-405-150m-50M
Wavespectrum laser Group.
www.wavespectrum-laser.com

405nm Pigtailed Diode Laser		150mW/MM Fiber		en.wavespectrum-laser.com.cn	
PARAMETER	SYMBOL	VALUE	UNIT		
Reverse Voltage	V_r	2.0	V		
Operating Temperature	T_{op}	0 ~ +70	°C		
Storage Temperature	T_{stg}	-40 ~ +85	°C		
Lead soldering temperature (10 sec.)	T_{is}	260	°C		
Features: <ul style="list-style-type: none"> ● 405nm ● UV Fiber ● Coaxial or Receptacle package ● CW or Pulsed Mode 					
Applications: <ul style="list-style-type: none"> ● Medical laser treatment ● Printing ● others 					
Specifications	WSLP-405-150m-50M				
	Min	Type	Max		
Center Wavelength@25°C	400nm	405nm	410nm		
Spectral Width (FWHM)	----	2.0nm	----		
Output Power	----	150mW	----		
Fiber Type	UV Multi-mode Fiber				
Fiber Core	50um				
Recommend Operating Temperature	25°C				
Fiber Connector	FC/SC/SMA905				
Fiber Length	80cm				
Threshold Current (Typ.)	----	40mA	60mA		
Operating Current (Typ.) For CW Mode	----	160mA	180mA		
Operating Voltage	----	4.8V	5.5V		
Package	Coaxial or Receptacle				

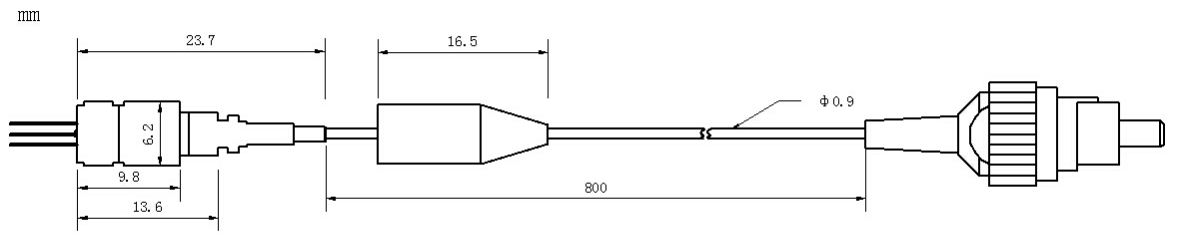

Coaxial Package View



PIN Bottom View:

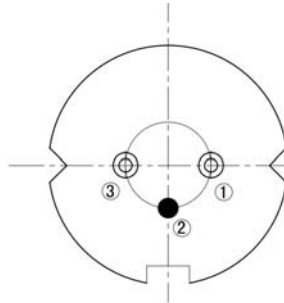

1	LD(+)
2	GND
3	LD(-)

Electrically shorten LD module and store in non-extreme conditions.
 Suggest using the constant current power supply.



Wavespectrum Laser Group
www.wavespectrum-laser.com
sales@wavespectrum-laser.com

