

405nm 250mW~300mW Multi-mode Fiber Coupled LD | Violet Laser Diode Module
405nm 300mW High Power Coaxial Pigtailed Diode Laser Module

WSLP-405-300m-105M

Wavespectrum laser Group.

www.wavespectrum-laser.com

405nm Pigtailed Diode Laser	300mW/MM Fiber	en.wavespectrum-laser.com.cn
------------------------------------	-----------------------	-------------------------------------

PARAMETER	SYMBOL	VALUE	UNIT
Reverse Voltage	V_r	2.0	V
Operating Temperature	T_{op}	0~+50	°C
Storage Temperature	T_{stg}	-40~+85	°C
Lead soldering temperature (10 sec.)	T_{is}	260	°C

Features: <ul style="list-style-type: none"> 405nm UV Fiber Coaxial or Receptacle package CW or Pulsed Mode 	
Applications: <ul style="list-style-type: none"> Medical laser treatment Printing others 	

Specifications	WSLP-405-300m-105M		
	Min	Type	Max
Center Wavelength@25°C	±3nm	405nm	±10nm
Spectral Width (FWHM)	----	2.0nm	----
Output Power	250mW	----	300mW
Fiber Type	UV Multi-mode Fiber		
Fiber Core	105um		
Recommend Operating Temperature	25°C		
Fiber Connector	FC/SC/SMA905		
Fiber Length	80cm		
Threshold Current (Typ.)	----	140mA	180mA
Operating Current (Typ.) For CW Mode	----	350mA	400mA
Operating Voltage	----	4.8V	5.5V
Package	Coaxial or Receptacle		



Coaxial Package View

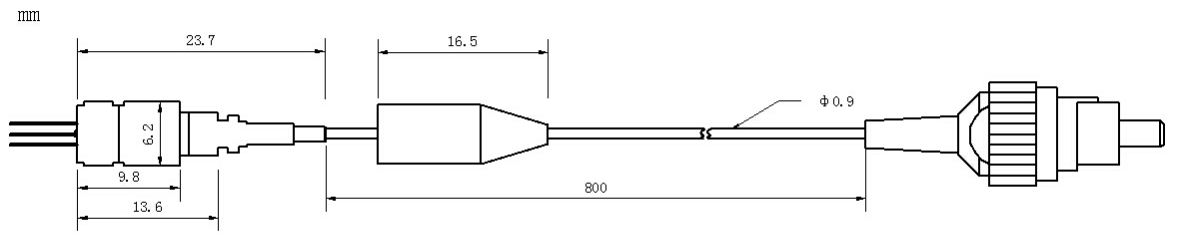

PIN Bottom View:

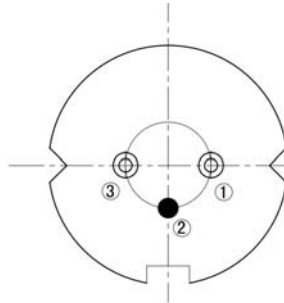

1	LD(+)
2	GND
3	LD(-)

Electrically shorten LD module and store in non-extreme conditions.
 Suggest using the constant current power supply.



Wavespectrum Laser Group
www.wavespectrum-laser.com
sales@wavespectrum-laser.com

