

635nm~638nm 250mW~300mW Fiber Coupled Laser Diodes With 105um Multi-mode Fiber
635nm 300mW High Power Pigtailed Diode Laser Module with Coaxial Package
 WSLP-635-300m-M Wavespectrum Laser Group www.wavespectrum-laser.com

635nm Pigtailed Diode Laser		Wavespectrum Laser Group	
PARAMETER	SYMBOL	VALUE	UNIT
Reverse Voltage	V_r	2.0	V
Operating Temperature	T_{op}	-10~+40	°C
Storage Temperature	T_{stg}	-40~+85	°C
Lead soldering temperature (10 sec.)	T_{is}	260	°C
Features: <ul style="list-style-type: none"> ● 635nm ● MM Fiber ● Coaxial Package 			
Applications: <ul style="list-style-type: none"> ● Medical Laser Treatment ● Others 			
Specifications	WSLP-635-300m-M		
	Min	Type	Max
Center Wavelength@25°C	630nm	638nm	645nm
Spectral Width (FWHM)	----	2.0nm	----
Output Power	250mW	300mW	----
Fiber Core	105um		
Recommended Operating Temperature	20°C		
Fiber Connector	FC/SC/SMA905		
Fiber Length	----	80cm	100cm
Threshold Current (Typ.)	----	200mA	300mA
Operating Current (Typ.)	----	900mA	1000mA
Operating Voltage	----	2.3V	2.6V
Package Style	Coaxial		

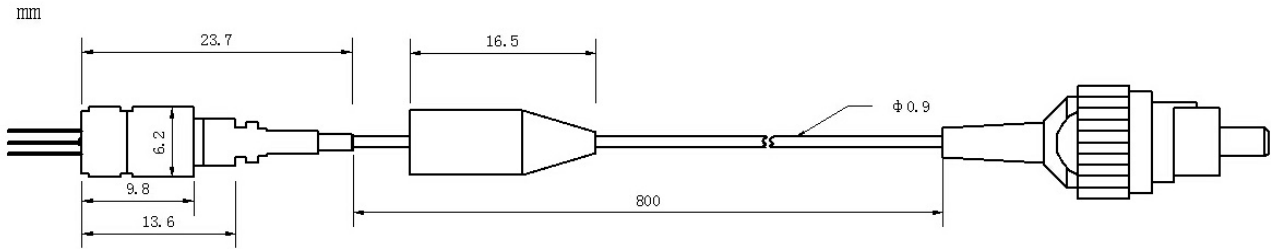

Coaxial Package View



PIN Bottom View:

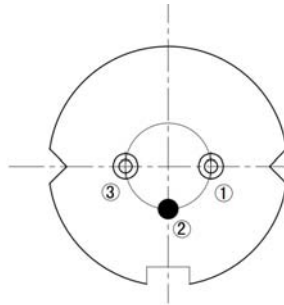

1	LD(+)
2	GND
3	LD(-)

Electrically shorten LD module and store in non-extreme conditions.

Suggest using the constant current power supply.

