

650nm~658nm 50mW~60mW Multi-mode Fiber Coupled Diode Laser | Red LD Module
650nm 60mW Coaxial Pigtailed Laser Diode with MMF | 62.5um, 105um Fiber Optional
WSLP-650-060m-M
Wavespectrum Laser Group
www.wavespectrum-laser.com

650nm Pigtailed Diode Laser		60mW/MM Fiber		Wavespectrum Laser Group	
PARAMETER	SYMBOL	VALUE		UNIT	
Reverse Voltage	V_r	2.0		V	
Operating Temperature	T_{op}	-10~+60		°C	
Storage Temperature	T_{stg}	-40 ~ +85		°C	
Lead soldering temperature (10 sec.)	T_{is}	260		°C	
Features: <ul style="list-style-type: none"> ● 650nm ● MM Fiber ● Coaxial package 					
Applications: <ul style="list-style-type: none"> ● Medical laser treatment ● Aiming beam ● Others 					
Specifications		WSLP-650-060m-M			
	Min	Type	Max		
Center Wavelength@25°C	650nm	658nm	665nm		
Recommended work Temperature	25°C				
Output Power	50mW	60mW	----		
Fiber Type	Multi-mode Fiber				
Fiber Core	62.5um (105um Option)				
Monitor Current	----	----	----		
PD Reverse Voltage	----	----	----		
Fiber Connector	FC/SC/SMA905				
Fiber Length	----	80cm	100cm		
Threshold Current (Typ.)	----	40mA	70mA		
Operating Current (Typ.)	----	170mA	200mA		
Operating Voltage	----	2.4V	3.0V		
Package Style	Coaxial				

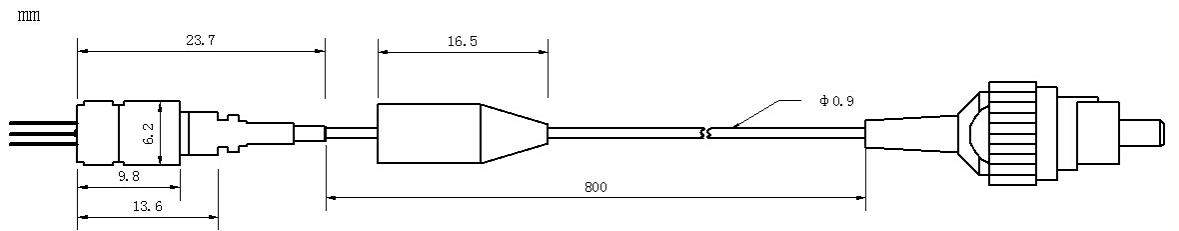

Coaxial Package View



PIN Bottom View:

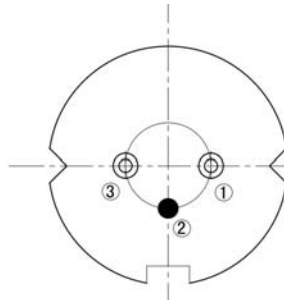

1	LD(+)
2	LD(-)
3	NC

Electrically shorten LD module and store in non-extreme conditions.
 Suggest using the constant current power supply.

