

**808nm 12W Fiber Coupled Laser Diode (LD) Module with HHL Package | Blue Green Red Aiming Beam**

**808nm~810nm|12W Power| HHL Package| 200um 400um Fiber Core| High Power LD|TEC Cooling**

**WSLB-808-012-H**

**Wavespectrum Laser Group**

**www.wavespectrum-laser.com**

PARAMETER	SYMBOL	VALUE	UNIT
Reverse Voltage	$V_r$	2.0	V
Operating Temperature	$T_{op}$	+10 ~ +30	°C
Storage Temperature	$T_{stg}$	-20 ~ +80	°C
Lead soldering temperature (10 sec.)	$T_{is}$	260	°C

**Features:**

- 808nm
- **Built-in** TEC Cooling Optional
- Aiming Beam Optional
- Photodiodes Optional
- Stainless Steel Armor Optional

**Applications:**

- Medical laser treatment
- Pumping
- Others

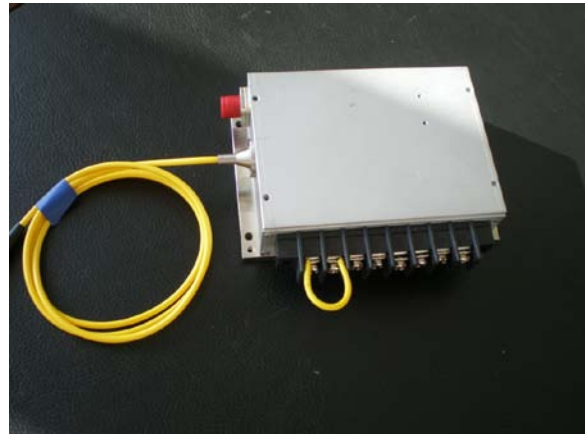

Specifications	WSLB-808-012-H		
	Min.	Type	Max.
Center Wavelength@25°C	±3nm	808nm	±10nm
Spectral Width (FWHM)	----	3nm	----
Output Power	----	12W	----
Temperature Coefficient of Wavelength	----	0.3nm / °C	----
Threshold Current (Typ.)	----	400mA	----
Operating Current (Typ.)	----	3.3A	----
Operating Voltage		7.4V	
Cooling	TEC Cooling Optional		
Fiber Core Diameter	300um		
Fiber Numerical Aperture	0.22		
Fiber Length	100cm		
Connector Type	FC (SMA905 Optional)		
Package	P2 Package		
Aiming Beam	Red (Blue ,Green Optional)		



Package View

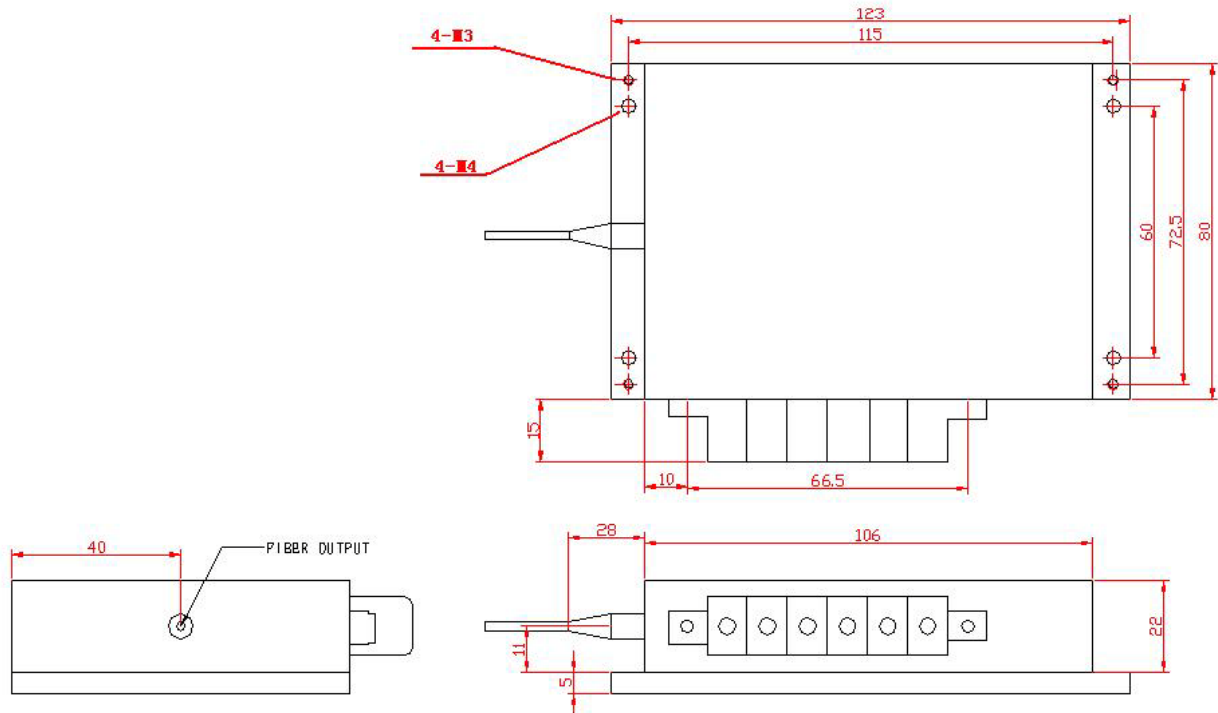

PIN	1	2	3	4	5	6
	LD(+)	LD(-)	RT	RT	TEC(-)	TEC(+)

Wavespectrum offer **Customized 808nm Fiber Coupled LD.**

Please let me know your special request:

- Customized Output Power
- Customized Fiber
- Customized Fiber Connector

Contact us with [info@wavespectrum-laser.com](mailto:info@wavespectrum-laser.com)

Electrically shorten LD module and store in non-extreme conditions.

Suggest using the constant current power supply.



Wavespectrum Laser, Inc.  
[www.wavespectrum-laser.com](http://www.wavespectrum-laser.com)  
[wavespectrumlaser@gmail.com](mailto:wavespectrumlaser@gmail.com)

