

488nm 20mW~30mW PM Coaxial Fiber Coupled Laser Diode with PMF | With Photodiode(PD)
488nm SM Pigtailed LD with Polarization Maintaining Fiber | With Zener Diode | ESD Protection
 WSLP-488-030m-PM-PD Wavespectrum Laser Group www.wavespectrum-laser.com

488nm Pigtailed Diode Laser		Wavespectrum Laser Group	
PARAMETER	SYMBOL	VALUE	UNIT
Reverse Current	I_r	20	mA
Operating Temperature	T_{op}	-20~+60	°C
Storage Temperature	T_{stg}	-40~+85	°C
Lead soldering temperature (10 sec.)	T_{is}	260	°C
Features: <ul style="list-style-type: none"> • 488nm Diode Laser • 3um PM Fiber • TEC Cooler Optional • Built-in Photodiode • With Zener Diode 			
Applications: <ul style="list-style-type: none"> • Medical Laser Treatment • Biomedical Applications • Metrology 			
Specifications	WSLP-488-030m-PM-PD		
	Min	Type	Max
Center Wavelength@25°C	+/-3nm	488nm	+/-10nm
Spectral Width (FWHM)	----	2.0nm	----
Output Power	20mW	----	30mW
Fiber Type	Polarization Maintaining Fiber		
Fiber Core	3um		
Recommend Operating Temperature	25°C		
Fiber Connector	FC/SC/SMA905		
Fiber Length	----	80cm	100cm
Threshold Current (Typ.)	----	30mA	50mA
Operating Current (Typ.)	----	80mA	110mA
Operating Voltage	----	6.5V	8.0V
Monitor Current	----	60uA	----
Package Style	Coaxial		

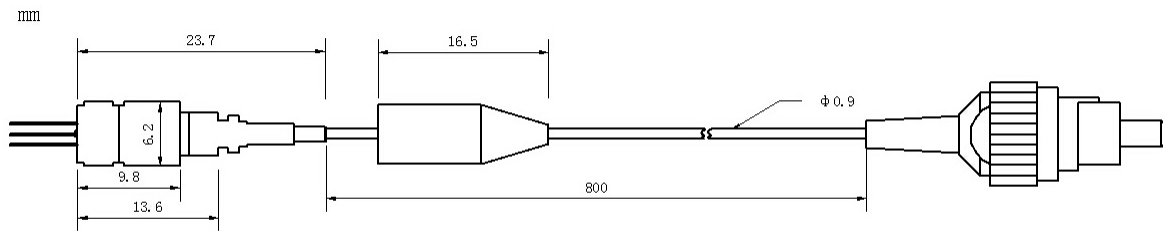

Coaxial Package View



PIN Bottom View:

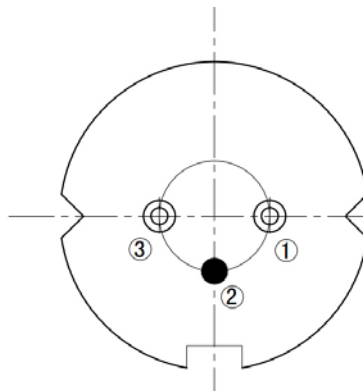

1	LD(+)
2	LD(-)&PD(-)
3	PD(+)

Electrically shorten LD module and store in non-extreme conditions.
 Suggest using the constant current power supply.

