

730nm 20mW~30mW SM Pigtailed Laser diode with PMF | Single Mode Laser Diode Module| With PD  
 720nm~730nm 30mW SM Fiber Coupled LD with Polarization Maintaining Fiber (PM Fiber) | Photodiode  
 WSLP-730-030m-PM-PD Wavespectrum Laser Group www.wavespectrum-laser.com

730nm Pigtailed Diode Laser		30mW/PM Fiber		Wavespectrum Laser Group	
PARAMETER	SYMBOL	VALUE		UNIT	
Reverse Voltage	$V_r$	2.0		V	
Operating Temperature	$T_{op}$	-10~+60		°C	
Storage Temperature	$T_{stg}$	-40~+85		°C	
Lead soldering temperature (10 sec.)	$T_{is}$	260		°C	
<b>Features:</b> <ul style="list-style-type: none"> <li>730nm</li> <li>With PM Fiber</li> <li>Coaxial Package</li> <li>Built-in PD</li> </ul>					
<b>Applications:</b> <ul style="list-style-type: none"> <li>Medical Laser Treatment</li> <li>Others</li> </ul>					
<b>Specifications</b>		<b>WSLP-730-030m-PM-PD</b>			
		Min	Type	Max	
Center Wavelength@25°C		±3nm	730nm	±10nm	
Recommend Operating Temperature		25°C			
Output Power		20mW	30mW	----	
Fiber Type		Polarization Maintaining Fiber			
Fiber Core		4um			
Monitor Current		----	0.5mA	----	
PD Reverse Voltage		----	30V	----	
Fiber Connector		FC/SC/SMA905			
Fiber Length		----	80cm	100cm	
Threshold Current (Typ.)		----	35mA	60mA	
Operating Current (Typ.)		----	80mA	100mA	
Operating Voltage		----	2.5V	3.0V	
Package Style		Coaxial			
PD		Built-in			

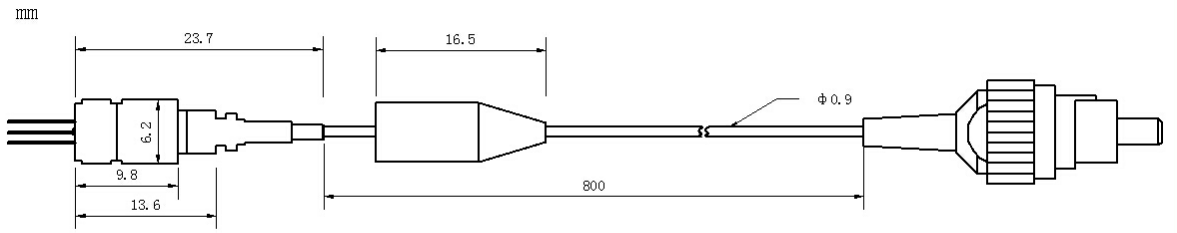

### Coaxial Package View



### PIN Bottom View:

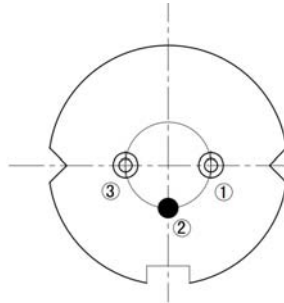

1	LD(-)
2	LD(+) & PD(-)
3	PD(+)

Electrically shorten LD module and store in non-extreme conditions.  
 Suggest using the constant current power supply.

