

## 1310nm 2mw FP Receptacle Laser Diode (LD)

### 1310nm Receptacle LD Module with SM Fiber

WSLR-1310-002m-9-FP

Wavespectrum laser inc.

www.wavespectrum-laser.com

PARAMETER	SYMBOL	VALUE	UNIT
LD Reverse Voltage	$V_r$	2.0	V
PD Operating Current	$I_{r(PD)}$	2.0	mA
PD Reverse Voltage	$V_{r(PD)}$	15	V
Operating Temperature	$T_{op}$	-10 ~ +85	°C
Storage Temperature	$T_{stg}$	-40 ~ +85	°C
Lead soldering temperature (10 sec.)	$T_{is}$	260	°C
<b>Features:</b> <ul style="list-style-type: none"> <li>1310nm</li> <li>FP Laser Diode</li> <li>Built-in Monitor</li> <li>Receptacle</li> <li>Isolation Optional</li> </ul>			
<b>Applications:</b> <ul style="list-style-type: none"> <li>Test Equipments</li> <li>Optical Bidi Module and Optical Receiver</li> <li>Optical Transmitter of Analog Signal</li> <li>Optical Transmitter of Data Signal</li> </ul>			
<b>Specifications</b>	<b>WSLR-1310-002m-9-FP</b>		
	Min	Type	Max
Center Wavelength@25°C	1290nm	1310nm	1330nm
Laser Type	FP		
Optical Fiber Output Power (After Fiber)	----	2mW	----
Fiber Specification	9um SM Fiber		
Threshold Current (Typ.) $I_{th}$	5mA	----	15mA
Operating Current	----	25mA	----
Forward Voltage		1.1V	1.6V
Monitor Current	0.1mA	----	----
PD Capacitance	----	10pF	15pF
PD Dark Current	----	----	0.1uA
Side Mode Suppression Ration	30dB	35dB	----
Package Style	Receptacle		
Data Rate	1.25Gb/s		2.5Gb/s
Isolation	Optional		
Ferrule Type	FC		



### FC Connector Receptacle Package View

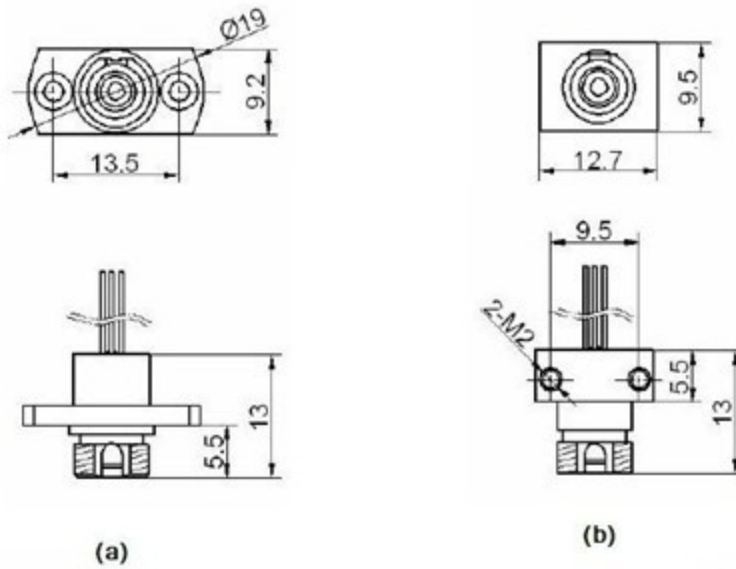

### Bottom View

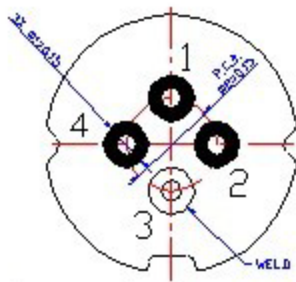

TYPE A  
PIN ASSIGNMENT:

1	PD Cathode
2	PD Anode
3	LD Anode, GND
4	LD Cathode

Electrically shorten LD module and store in non-extreme conditions.  
Suggest using the constant current power supply.



Please contact us:

Website: [www.wavespectrum-laser.com](http://www.wavespectrum-laser.com) (for more detailed information)

Email: [info@wavespectrum-laser.com](mailto:info@wavespectrum-laser.com) (for inquiry about this product)

