

### 1310nm Receptacle Laser Diode (LD) with SMF

### 1310nm SM 10mw DFB Receptacle LD Module with 9um Fiber

WSLR-1310-010m-9-DFB

Wavespectrum laser inc.

www.wavespectrum-laser.com

PARAMETER	SYMBOL	VALUE	UNIT
LD Reverse Voltage	$V_r$	2.0	V
PD Reverse Voltage	$V_{r(PD)}$	15	V
Operating Temperature	$T_{op}$	-10 ~ +85	°C
Storage Temperature	$T_{stg}$	-40 ~ +85	°C
Lead soldering temperature (10 sec.)	$T_{is}$	260	°C

<b>Features:</b> <ul style="list-style-type: none"> <li>• 1310nm</li> <li>• DFB Laser Diode</li> <li>• Built-in Monitor</li> <li>• Isolation Optional</li> <li>• Receptacle package</li> </ul>			
<b>Applications:</b> <ul style="list-style-type: none"> <li>• Test Equipments</li> <li>• Optical Bidi Module and Optical Receiver</li> <li>• Optical Transmitter of Analog Signal</li> <li>• Optical Transmitter of Data Signal</li> </ul>			
<b>Specifications</b>	<b>WSLR-1310-010m-9-DFB</b>		
	Min	Type	Max
Center Wavelength@25°C	1290nm	1310nm	1330nm
Laser Type	DFB		
Optical Fiber Output Power (After Fiber)	----	10mW	----
Fiber Specification	9um SM Fiber		
Threshold Current (Typ.) $I_{th}$	----	12mA	----
Operating Current	----	60mA	----
Operating Voltage	----	1.4V	----
Spectral Width(nm@20dB)	----	0.23	----
SMRS	----	35dB	----
Rs(ohms)	----	12.98	----
Monitor Current	0.1mA	----	----
PD Capacitance	----	10pF	15pF
PD Dark Current	----	----	0.1uA
Slope	----	0.38W/A	----
Package Style	Receptacle		
Ferrule Type	FC		

Modulation Frequency upto 2GHz



### FC Connector Receptacle Package View

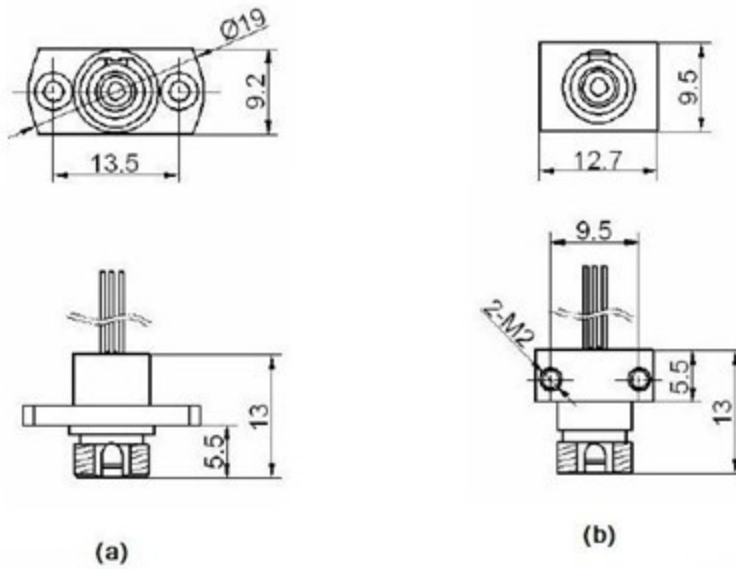

### Bottom View

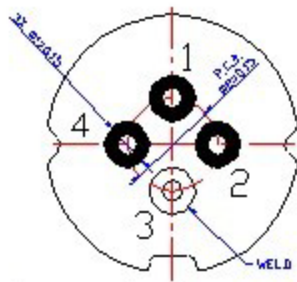

#### TYPE A PIN ASSIGNMENT:

1	PD Cathode
2	PD Anode
3	LD Anode, GND
4	LD Cathode

Electrically shorten LD module and store in non-extreme conditions.

Suggest using the constant current power supply.



Please contact us:

Website: [www.wavespectrum-laser.com](http://www.wavespectrum-laser.com) (for more detailed information)

Email: [info@wavespectrum-laser.com](mailto:info@wavespectrum-laser.com) (for inquiry about this product)

