

**405nm 1mW~2mW SM Coaxial Pigtailed Laser Diode | Built-in Photodiode**

**405nm 1mW Fiber Coupled LD with Single Mode Fiber | Violet Diode Laser Module with PD**

WSLP-405-002m-4-PD

Wavespectrum Laser Group

www.wavespectrum-laser.com

en.wavespectrum-laser.com.cn

PARAMETER	SYMBOL	VALUE	UNIT
Reverse Voltage	$V_r$	2.0	V
Operating Temperature	$T_{op}$	0~+75	°C
Storage Temperature	$T_{stg}$	-40~+85	°C
Lead soldering temperature (10 sec.)	$T_{is}$	260	°C
<b>Features:</b> <ul style="list-style-type: none"> <li>● 405nm</li> <li>● 3um SM Fiber</li> <li>● Coaxial Package</li> <li>● Built-in Photodiode</li> </ul>			
<b>Applications:</b> <ul style="list-style-type: none"> <li>● Medical laser treatment</li> <li>● Printing</li> <li>● Others</li> </ul>			
<b>Specifications</b>	<b>WSLP-405-002m-4-PD</b>		
	Min	Type	Max
Center Wavelength@25°C	$\pm 3nm$	405nm	$\pm 10nm$
Spectral Width (FWHM)	----	2.0nm	----
Output Power	1mW	----	2mW
Fiber Core	3um		
Recommend Operating Temperature	25°C		
Monitor Current	----	0.2mA	----
PD Reverse Voltage	----	30V	----
Fiber Connector	FC/SC/SMA905		
Fiber Length	----	80cm	100cm
Threshold Current (Typ.)	----	26mA	50mA
Operating Current (Typ.)	----	45mA	60mA
Operating Voltage	----	4.8V	5.6V
Package Style	Coaxial		
PD	Built-in		



### Coaxial Package View

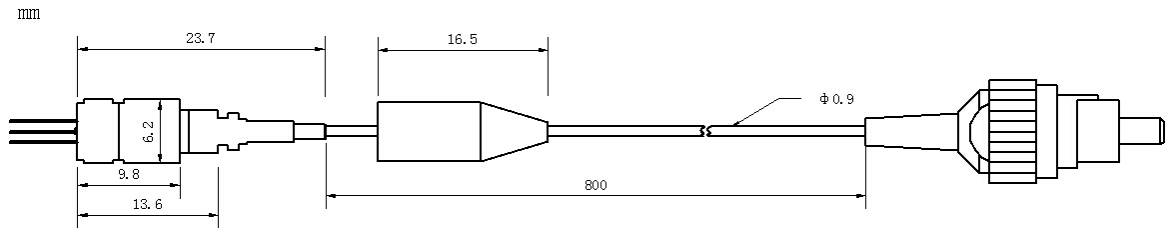

### PIN Bottom View:

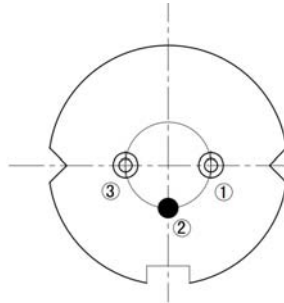

1	LD(+)
2	LD(-)&PD(-)
3	PD(+)

Electrically shorten LD module and store in non-extreme conditions.  
 Suggest using the constant current power supply.

