

520nm Green 5mW SM Coaxial Fiber Coupled Laser Diode with SMF | Built-in Photodiode
515nm~520nm~530nm SM Pigtailed LD with Single Mode Fiber (SM Fiber) | With PD

WSLP-520-005m-4-PD

Wavespectrum Laser Group

www.wavespectrum-laser.com

| 520nm Pigtailed Diode Laser | | Wavespectrum Laser Group | |
|--|--|--------------------------|---------|
| PARAMETER | SYMBOL | VALUE | UNIT |
| Reverse Voltage | V_r | 2.0 | V |
| Operating Temperature | T_{op} | -20~+60 | °C |
| Storage Temperature | T_{stg} | -40~+85 | °C |
| Lead soldering temperature (10 sec.) | T_{is} | 260 | °C |
| Features: <ul style="list-style-type: none"> 🔸 520nm Green Diode Laser 🔸 3um SM Fiber 🔸 Coaxial Package 🔸 Built-in Photodiode |  | | |
| Applications: <ul style="list-style-type: none"> 🔸 Medical Laser Treatment 🔸 Others | | | |
| Specifications | WSLP-520-005m-4-PD | | |
| | Min | Type | Max |
| Center Wavelength@25°C | +/-5nm | 520nm | +/-10nm |
| Spectral Width (FWHM) | ---- | 2.0nm | ---- |
| Output Power | ---- | 5mW | ---- |
| Fiber Type | Single Mode Fiber | | |
| Fiber Core | 3um | | |
| PD Current | 100uA | | |
| Recommend Operating Temperature | 25°C | | |
| Fiber Connector | FC | | |
| Fiber Length | ---- | 80cm | 100cm |
| Threshold Current (Typ.) | ---- | 40mA | 75mA |
| Operating Current (Typ.) | ---- | 160mA | 180mA |
| Operating Voltage | ---- | 7.5V | 8.0V |
| Package Style | Coaxial | | |
| Photodiode | Built-in | | |



Coaxial Package View

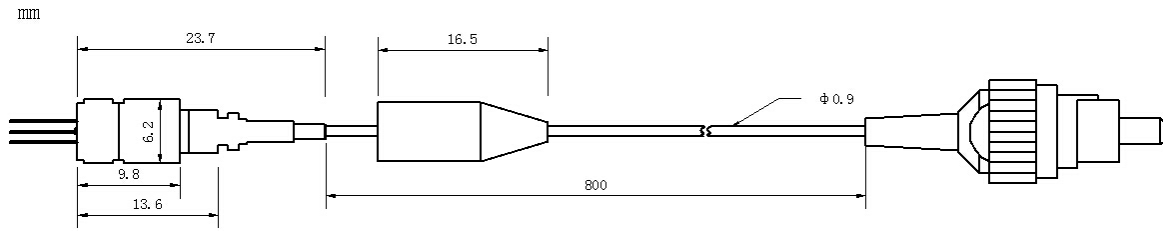

PIN Bottom View:

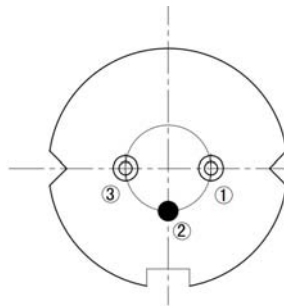

| | |
|----------|------------------------|
| 1 | LD(-) |
| 2 | LD(+)&PD(-) |
| 3 | PD(+) |

Electrically shorten LD module and store in non-extreme conditions.
 Suggest using the constant current power supply.

