

635nm 3mW~4mW SM Fiber Coupled Laser Diode with 4um Coaxial Package | Built-in PD
635nm~638nm Pigtail Laser Diode with 4um Single Mode Fiber | Red LD with Photodiode
WSLP-635-003m-4-PD **Wavespectrum Laser Group** **www.wavespectrum-laser.com**

635nm Pigtailed Diode Laser		3mW/SM Fiber		Wavespectrum Laser Group	
PARAMETER	SYMBOL	VALUE	UNIT		
Reverse Voltage	V_r	2.0	V		
Operating Temperature	T_{op}	-10~+40	°C		
Storage Temperature	T_{stg}	-40 ~ +85	°C		
Lead soldering temperature (10 sec.)	T_{is}	260	°C		
Features: <ul style="list-style-type: none"> 🔸 635nm 🔸 4um SM Fiber 🔸 Coaxial Package 🔸 Built-in PD 					
Applications: <ul style="list-style-type: none"> 🔸 Medical laser treatment 🔸 Aiming beam 🔸 Others 					
Specifications	WSLP-635-003m-4-PD				
	Min	Type	Max		
Center Wavelength@25°C	630nm	638nm	645nm		
Recommended work Temperature	25°C				
Output Power	----	3mW	----		
Fiber Type	Single Mode Fiber				
Fiber Core	4um				
Monitor Current	----	0.5mA	----		
PD Reverse Voltage	----	30V	----		
Fiber Connector	FC/SC/SMA905				
Fiber Length	----	80cm	100cm		
Threshold Current (Typ.)	----	50mA	70mA		
Operating Current (Typ.)	----	100mA	120mA		
Operating Voltage	----	2.3V	2.8V		
Package Style	Coaxial				
PD	Built-in				

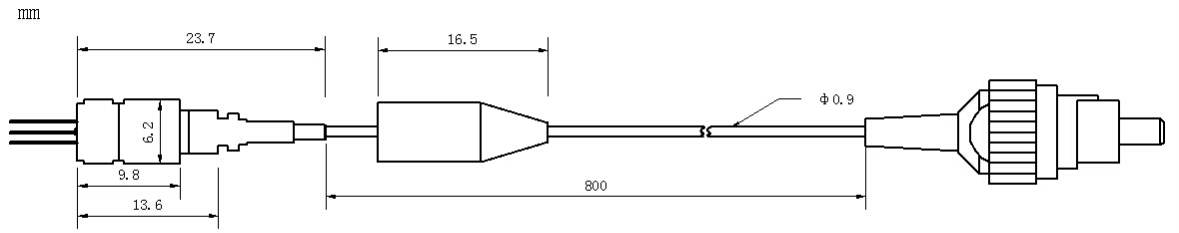

Coaxial Package View



PIN Bottom View:

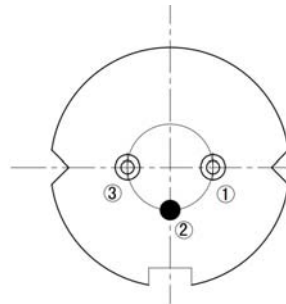

1	LD(-)
2	LD(+)&PD(-)
3	PD(+)

Electrically shorten LD module and store in non-extreme conditions.
 Suggest using the constant current power supply.

