

**635nm~638nm 5mW Single Mode Fiber Coupled Diode Laser with Coaxial Package | Red LD**

**635nm 5mW Pigtail Laser Diode with 4um Single Mode Fiber (SM Fiber) | Built-in PD**

WSLP-635-005m-4-PD

Wavespectrum Laser Group

www.wavespectrum-laser.com

635nm Pigtailed Diode Laser		Wavespectrum Laser Group	
PARAMETER	SYMBOL	VALUE	UNIT
Reverse Voltage	$V_r$	2.0	V
Operating Temperature	$T_{op}$	-10~+40	°C
Storage Temperature	$T_{stg}$	-40~+85	°C
Lead soldering temperature (10 sec.)	$T_{is}$	260	°C
<b>Features:</b> <ul style="list-style-type: none"> <li>● 635nm</li> <li>● 4um SM Fiber</li> <li>● Coaxial Package</li> <li>● Built-in PD</li> </ul>			
<b>Applications:</b> <ul style="list-style-type: none"> <li>● Medical Laser Treatment</li> <li>● Aiming Beam</li> <li>● Others</li> </ul>			
<b>Specifications</b>	<b>WSLP-635-005m-4-PD</b>		
	Min	Type	Max
Center Wavelength@25°C	630nm	638nm	645nm
Recommended work Temperature	25°C		
Output Power	----	5mW	----
Fiber Type	Single Mode Fiber		
Fiber Core	4um		
Monitor Current	----	0.5mA	----
PD Reverse Voltage	----	30V	----
Fiber Connector	FC/SC/SMA905		
Fiber Length	----	80cm	100cm
Threshold Current (Typ.)	----	55mA	75mA
Operating Current (Typ.)	----	100mA	120mA
Operating Voltage	----	2.5V	3.0V
Package Style	Coaxial		
PD	Built-in		



### Coaxial Package View

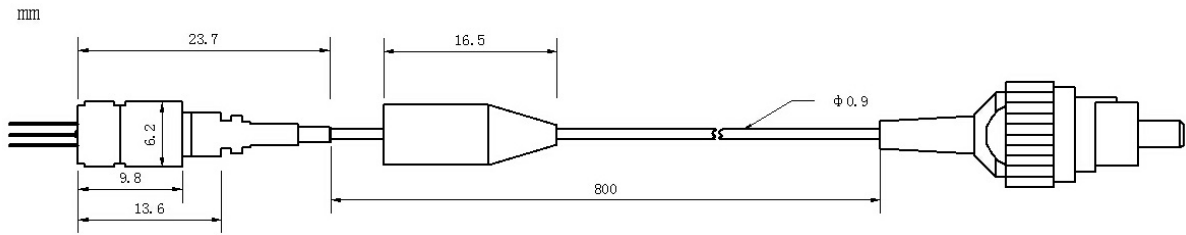

### PIN Bottom View:

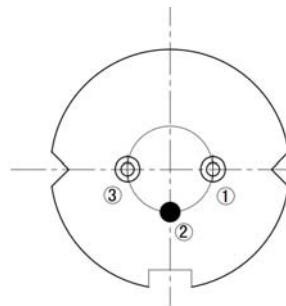

1	LD(-)
2	LD(+)&PD(-)
3	PD(+)

Electrically shorten LD module and store in non-extreme conditions.  
 Suggest using the constant current power supply.

