

650nm~660nm 20mW SM Fiber Coupled Laser Diode with 4um SMF
650nm 20mW Coaxial Pigtailed LD with Single Mode Fiber (SM Fiber) | Red Diode Laser Module
WSLP-650-020m-4
Wavespectrum Laser Group
www.wavespectrum-laser.com

650nm Pigtailed Diode Laser		20mW/SM Fiber		Wavespectrum Laser Group	
PARAMETER	SYMBOL	VALUE	UNIT		
Reverse Voltage	V_r	2.0	V		
Operating Temperature	T_{op}	-10~+60	°C		
Storage Temperature	T_{stg}	-40~+85	°C		
Lead soldering temperature (10 sec.)	T_{is}	260	°C		
Features: <ul style="list-style-type: none"> ● 650nm ● Single Mode Fiber ● Coaxial Package 					
Applications: <ul style="list-style-type: none"> ● Medical laser treatment ● Other 					
Specifications	WSLP-650-020m-4				
	Min	Type	Max		
Center Wavelength@25°C	650nm	658nm	665nm		
Spectral Width (FWHM)	----	2.0nm	----		
Output Power	----	20mW	----		
Fiber Type	Single Mode Fiber				
Fiber Core	4um				
Recommend Operating Temperature	25°C				
Fiber Connector	FC/SC/SMA905				
Fiber Length	----	80cm	100cm		
Threshold Current (Typ.)	----	50mA	75mA		
Operating Current (Typ.)	----	200mA	230mA		
Operating Voltage	----	2.4V	3.0V		
Package Style	Coaxial				

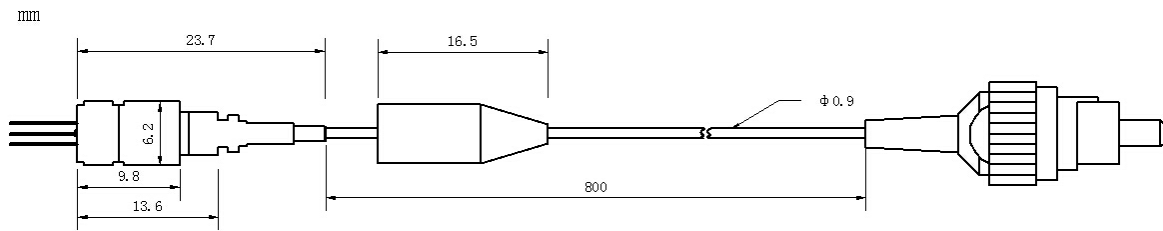

Coaxial Package View



PIN Bottom View:

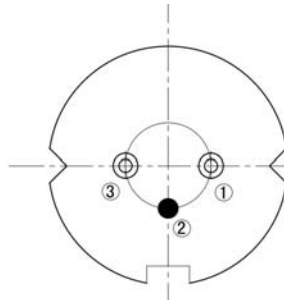

1	LD(+)
2	LD(-)
3	NC

Electrically shorten LD module and store in non-extreme conditions.
 Suggest using the constant current power supply.



More information please contact us:

Website: www.wavespectrum-laser.com , en.wavespectrum-laser.com

Email: Info@wavespectrum-laser.com , sales@wavespectrum-laser.com

