

650nm~660nm 30mw~40mw SM Fiber Coupled Laser Diode Module with 4um SMF
658nm Coaxial Pigtailed LD with Single Mode Fiber (SM Fiber)
WSLP-650-040m-4
Wavespectrum Laser Group
www.wavespectrum-laser.com

650nm Pigtailed Diode Laser		40mW/SM Fiber		Wavespectrum Laser Group	
PARAMETER	SYMBOL	VALUE	UNIT		
Reverse Voltage	V_r	2.0		V	
Operating Temperature	T_{op}	-10~+50		°C	
Storage Temperature	T_{stg}	-40~+85		°C	
Lead soldering temperature (10 sec.)	T_{is}	260		°C	
Features: <ul style="list-style-type: none"> ● 650nm ● Single Mode Fiber ● Coaxial Package 					
Applications: <ul style="list-style-type: none"> ● Medical laser treatment ● Other 					
Specifications	WSLP-650-040m-4				
	Min	Type	Max		
Center Wavelength@25°C	654nm	658nm	665nm		
Spectral Width (FWHM)	----	2.0nm	----		
Output Power	30mW	40mW	----		
Fiber Type	Single Mode Fiber				
Fiber Core	4um				
Recommend Operating Temperature	25°C				
Fiber Connector	FC				
Fiber Length	----	80cm	100cm		
Threshold Current (Typ.)	----	55mA	75mA		
Operating Current (Typ.)	----	260mA	280mA		
Operating Voltage	----	2.6V	3.0V		
Package Style	Coaxial				

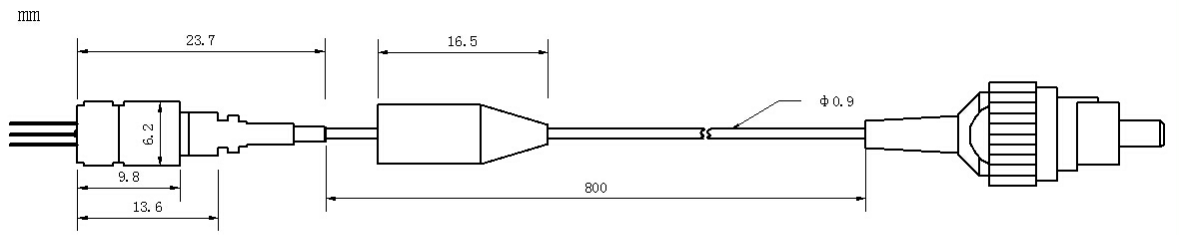

Coaxial Package View



PIN Bottom View:

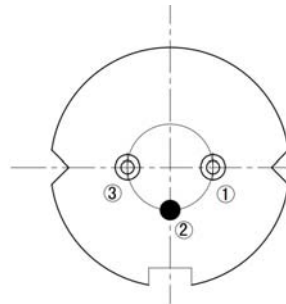

1	LD(+)
2	LD(-)
3	NC

Electrically shorten LD module and store in non-extreme conditions.
 Suggest using the constant current power supply.

