

670nm 1mw~2mw SM Coaxial Pigtailed Laser Diode with SMF | 4um SMF| Built-in Photodiode

670nm~675nm SM Fiber Coupled LD with Single Mode Fiber | With PD | Single Mode Beam

WSLP-670-002m-4-PD

Wavespectrum Laser Group

www.wavespectrum-laser.com

670nm Pigtailed Diode Laser		Wavespectrum Laser Group	
PARAMETER	SYMBOL	VALUE	UNIT
Reverse Voltage	V_r	2.0	V
Operating Temperature	T_{op}	-10~+60	°C
Storage Temperature	T_{stg}	-40~+85	°C
Lead soldering temperature (10 sec.)	T_{is}	260	°C
Features: <ul style="list-style-type: none"> • 670nm • With SM Fiber • Coaxial Package • Built-in PD 			
Applications: <ul style="list-style-type: none"> • Medical Laser Treatment • Others 			
Specifications	WSLP-670-002m-4-PD		
	Min	Type	Max
Center Wavelength@25°C	±3nm	670nm	±10nm
Recommend Operating Temperature	25°C		
Output Power	1mW	2mW	----
Fiber Type	Single Mode		
Fiber Core	4um		
Monitor Current	----	1mA	----
PD Reverse Voltage	----	30V	----
Fiber Connector	FC		
Fiber Length	----	80cm	100cm
Threshold Current (Typ.)	----	20mA	30mA
Operating Current (Typ.)	----	30mA	40mA
Operating Voltage	----	2.2V	2.7V
Package Style	Coaxial		
PD	Built-in		



Coaxial Package View

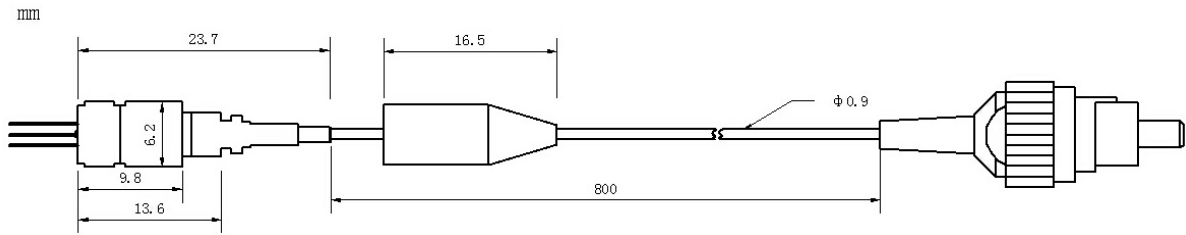

PIN Bottom View:

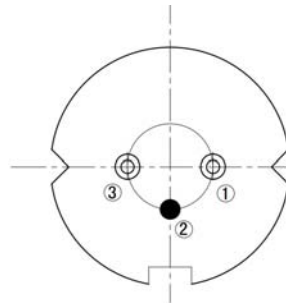

1	LD(-)
2	LD(+)&PD(-)
3	PD(+)

Electrically shorten LD module and store in non-extreme conditions.
 Suggest using the constant current power supply.

