

670nm 3mw SM Coaxial Pigtailed Laser Diode with SMF | 4um SMF| Built-in Photodiode

670nm~675nm SM Fiber Coupled LD with Single Mode Fiber | With PD | Single Mode Beam

WSLP-670-003m-4-PD

Wavespectrum Laser Group

www.wavespectrum-laser.com

670nm Pigtailed Diode Laser		Wavespectrum Laser Group	
PARAMETER	SYMBOL	VALUE	UNIT
Reverse Voltage	$V_r$	2.0	V
Operating Temperature	$T_{op}$	-10~+60	°C
Storage Temperature	$T_{stg}$	-40~+85	°C
Lead soldering temperature (10 sec.)	$T_{is}$	260	°C
<b>Features:</b> <ul style="list-style-type: none"> <li>🔸 670nm</li> <li>🔸 With SM Fiber</li> <li>🔸 Coaxial Package</li> <li>🔸 Built-in PD</li> </ul>			
<b>Applications:</b> <ul style="list-style-type: none"> <li>🔸 Medical Laser Treatment</li> <li>🔸 Others</li> </ul>			
<b>Specifications</b>	<b>WSLP-670-003m-4-PD</b>		
	Min	Type	Max
Center Wavelength@25°C	±3nm	670nm	±10nm
Recommend Operating Temperature	25°C		
Output Power	----	3mW	----
Fiber Type	Single Mode		
Fiber Core	4um		
Monitor Current	----	1mA	----
PD Reverse Voltage	----	30V	----
Fiber Connector	FC		
Fiber Length	----	80cm	100cm
Threshold Current (Typ.)	----	20mA	30mA
Operating Current (Typ.)	----	35mA	45mA
Operating Voltage	----	2.3V	2.8V
Package Style	Coaxial		
PD	Built-in		



### Coaxial Package View

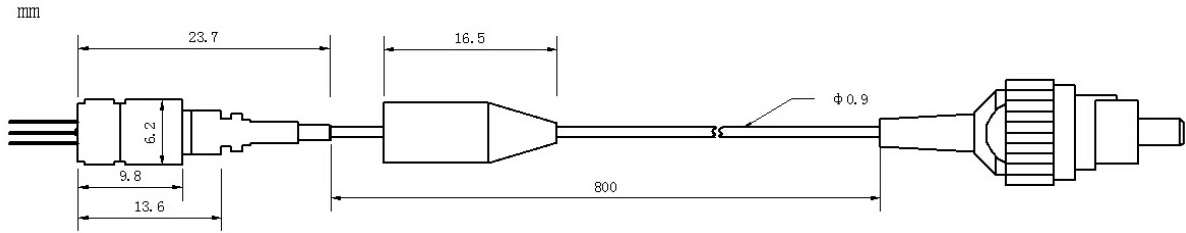

### PIN Bottom View:

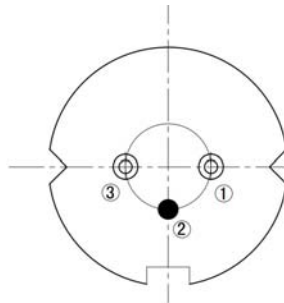

1	LD(-)
2	LD(+)&PD(-)
3	PD(+)

Electrically shorten LD module and store in non-extreme conditions.  
 Suggest using the constant current power supply.



Wavespectrum Laser Group  
[www.wavespectrum-laser.com](http://www.wavespectrum-laser.com)  
[sales@wavespectrum-laser.com](mailto:sales@wavespectrum-laser.com)

